

# "O-RING SEAL"

## T A P E R E D P I P E T H R E A D

**250**  
**FEMALE CONNECTOR**  
**TUBE END-FEMALE PIPE END**

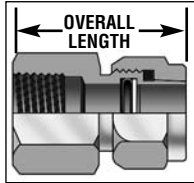
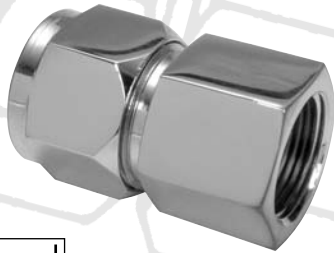

**300**  
**UNION**  
**TUBE END-BOTH ENDS**

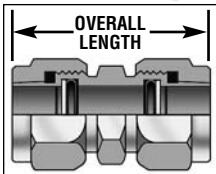

**350**  
**MALE 45° ELBOW - TUBE END**  
**MALE PIPE END**

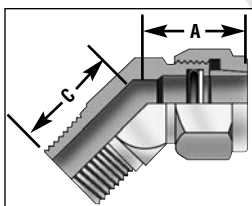

**250 • Female Connector**

Part No.	Tube O.D.	Female Pipe Thread	Overall Length
250-4-2*	1/4"	1/8"	1 11/32"
250-4-4*	1/4"	1/4"	1 15/32"
250-5-2*	5/16"	1/8"	1 11/32"
250-5-4*	5/16"	1/4"	1 15/32"
250-6-4*	3/8"	1/4"	1 17/32"
250-6-2	3/8"	1/8"	1 7/32"
250-6-6*	3/8"	3/8"	1 21/32"
250-8-6*	1/2"	3/8"	1 7/8"
250-8-4	1/2"	1/4"	1 19/32"
250-8-8*	1/2"	1/2"	2 1/16"
250-10-8*	5/8"	1/2"	2 5/32"
250-10-4	5/8"	1/4"	1 23/32"
250-10-6	5/8"	3/8"	1 23/32"
250-12-12*	3/4"	3/4"	2 5/16"
250-12-8	3/4"	1/2"	2 1/16"
250-14-12*	7/8"	3/4"	2 5/16"
250-14-20*	7/8"	1 1/4"	2 11/16"
250-16-16*	1"	1"	2 23/32"
250-16-12	1"	3/4"	2 7/32"
250-16-24*	1"	1 1/2"	2 29/32"
250-18-16*	1 1/8"	1"	2 11/16"
250-20-20*	1 1/4"	1 1/4"	3"
250-24-24*	1 1/2"	1 1/2"	3 5/32"
250-24-20*	1 1/2"	1 1/4"	2 25/32"
250-32-32*	2"	2"	3 19/32"

\* Fittings with tube diameter bored through

**300 • Union**

Part No.	Tube O.D.	Overall Length
300-2	1/8"	1 5/16"
300-4	1/4"	1 11/16"
300-5	5/16"	1 11/16"
300-6	3/8"	1 13/16"
300-8	1/2"	2 9/32"
300-10	5/8"	2 9/16"
300-12	3/4"	2 7/8"
300-14	7/8"	2 15/16"
300-16	1"	3 3/16"
300-20	1 1/4"	3 3/4"
300-24	1 1/2"	4 1/16"
300-32	2"	4 15/16"

**350 • Male 45° Elbow**

Part No.	Tube O.D.	Male Pipe Thread	"A" (Tube Leg)	"C" (Male Pipe Leg)
350-4-2	1/4"	1/8"	25/32"	5/8"
350-5-2	5/16"	1/8"	7/8"	5/8"
350-6-4	3/8"	1/4"	1"	2 7/32"
350-6-6	3/8"	3/8"	1"	1 5/16"
350-8-6	1/2"	3/8"	1 7/32"	1 5/16"
350-8-4	1/2"	1/4"	1 7/32"	1 5/16"
350-8-8	1/2"	1/2"	1 15/32"	1 5/32"
350-10-8	5/8"	1/2"	1 15/32"	1 5/32"
350-12-12	3/4"	3/4"	1 5/8"	1 3/16"
350-12-8	3/4"	1/2"	1 5/8"	1 5/32"
350-14-12	7/8"	3/4"	1 9/16"	1 1/4"
350-16-16	1"	1"	1 13/16"	1 15/32"
350-16-12	1"	3/4"	1 13/16"	1 9/32"
350-20-20	1 1/4"	1 1/4"	2 7/32"	1 21/32"
350-24-24	1 1/2"	1 1/2"	2 13/32"	1 3/4"
350-32-32	2"	2"	2 15/16"	2 1/32"